

620 N. Main Street Greenville, SC 29601

Renovated Downtown Office Space
Available for Lease on Main Street with
Ample Natural Light

Property Type	Office
Status	For Lease
Lease Rate	\$16.97-\$19.00/SF
Square Feet	+/- 9,700 Square Feet
County	Greenville
Tax Map	0034000100900

AGENT CONTACT



GARY KIRBY

gkirby@kdscaine.com

O: 864-242-4200

M: 864-650-5556



PROPERTY FEATURES

- Entire second floor of Downtown Greenville Office - Available for 3 year sublease or longer full term
- ±9,700 Full Service | Can be divided into 2,829, 5,064, or 9,700 SF
- Large Bull Pen Area
- 10 on-site parking spaces with 70 Additional Available Nearby
- Conveniently Located in North Main Neighborhood with Close Proximity to Main Street Retail and Dining
- 10+ Hard walled offices, 3 Conference Rooms, Break Rooms
- Recent Modern update of suites with demised offices, multiple conference rooms and open bullpen area with natural light



All information contained herein has been obtained from sources deemed reliable, but we cannot guarantee it. It is also subject to change without notice.

340 Rocky Slope Rd., Suite 302, Greenville, SC 29607

☎ 864-242-4200 • kdscaine.com • ✉ admin@kdscaine.com

PHOTOS

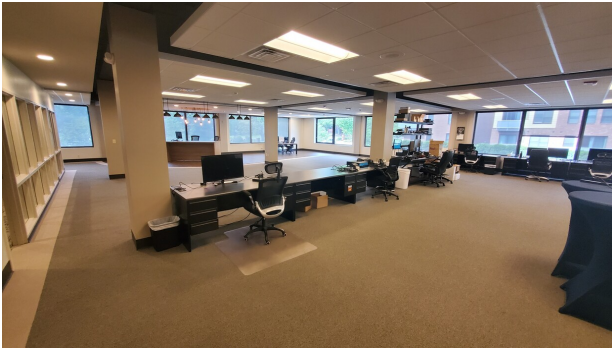

All information contained herein has been obtained from sources deemed reliable, but we cannot guarantee it. It is also subject to change without notice.

340 Rocky Slope Rd., Suite 302, Greenville, SC 29607

☎ 864-242-4200 · kdscaine.com · ✉ admin@kdscaine.com

FLOOR PLAN

Floor Plan Layout

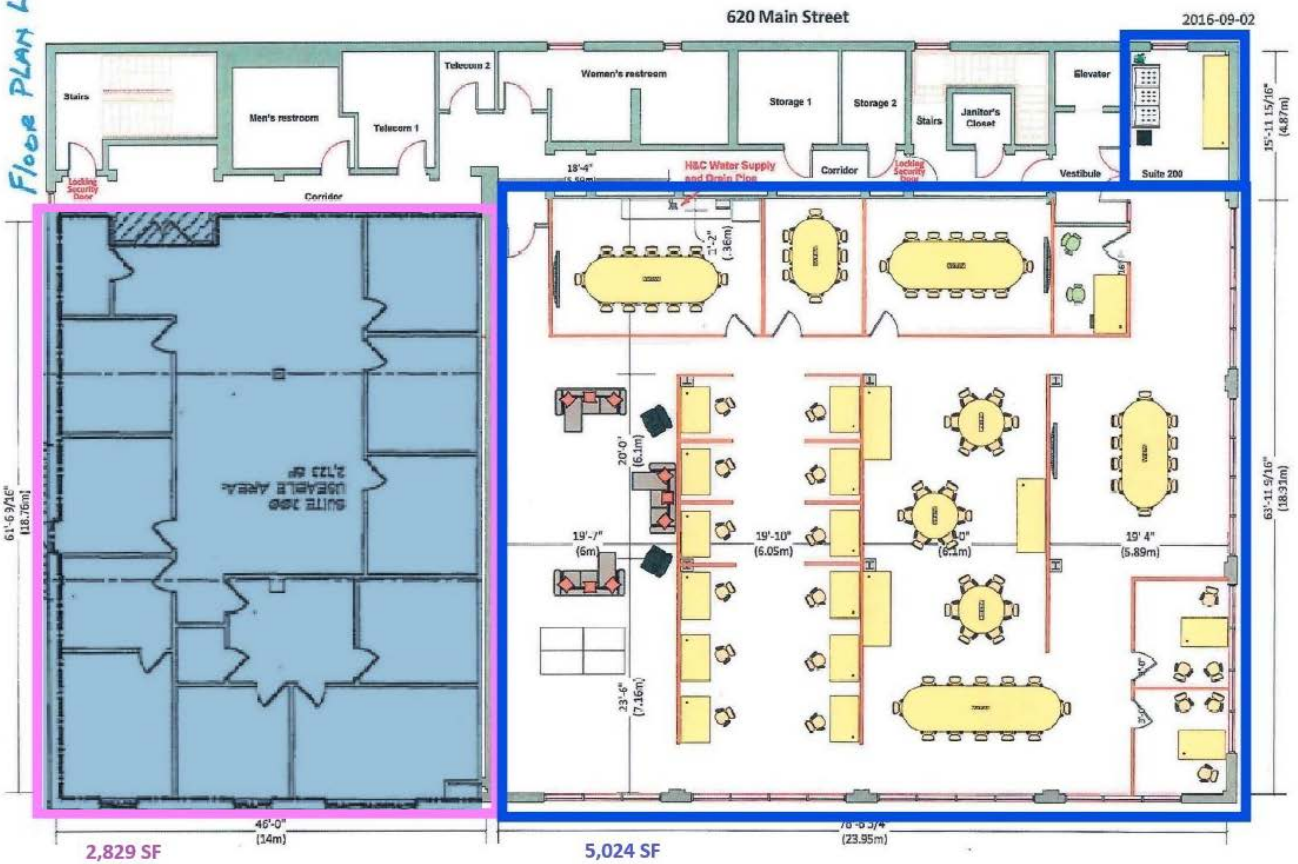

All information contained herein has been obtained from sources deemed reliable, but we cannot guarantee it. It is also subject to change without notice.

340 Rocky Slope Rd., Suite 302, Greenville, SC 29607

☎ 864-242-4200 • kdscaine.com • ✉ admin@kdscaine.com