

Space Available in Simpsonville's Burdette Central Historic Redevelopment



Property Features

Lease Price	\$28- \$30
Zoning	ID
AC / SF	+/- 2.092 AC +/- 3,991 SF
County	Greenville
Tax Map #	0311000100100
Additional Details	<ul style="list-style-type: none"> • Historical community gathering space in heart of Downtown Simpsonville • 2020 Recipient of the SC historic Preservation Award • 25,000 SF Multi-tenant Development • Available Space: +/- 2,339 SF (104B) +/- 1,652 SF (108A)





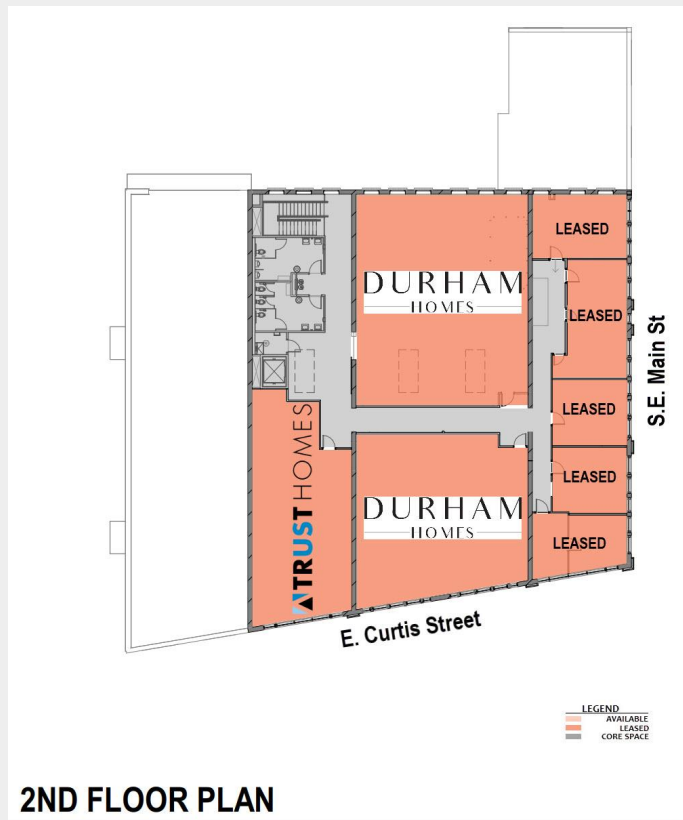

	1 Mile	3 Miles
Population	8,866	48,467
Households	4,191	20,799
Median Age	40.1	39.2
Median HH Income	\$66,201	\$78,257
Daytime Employees	2,065	11,952
Pop Growth '22 - '27	2.5%	2.50%



BROKER

Martin Pazdan
 M: 864-270-4598
 martin@kdsproperties.com

Burdette Hardware was a family run business that started in 1899. The store was both a retail and a community hub in the heart of Downtown Simpsonville. Through a transformational redevelopment in 2020 with a focus of preserving its history, Burdette still stays true to its origins as being a community gathering space with tenants including Sidewall Pizza, Chestnut Coffee, Farm Fresh Fast, Smoqed BBQ, Run In, and 1885 Tap Room.”