

CERTIFICATE OF OWNERSHIP AND DEDICATION

The undersigned hereby acknowledge that I am (we are) the owner(s) of the property shown and described hereon and that I (we) hereby adopt this plan of subdivision with my (our) free consent and that I (we) establish the minimum building restriction lines, and hereby dedicate to public use as roads, streets, and easements, forever all areas so shown or indicated on said plot.

THOMAS M EDWARDS JR
By: _____ Date _____
Name: _____
Title: _____

CALDWELL CONSTRUCTORS
By: _____ Date _____
Name: _____
Title: _____

CERTIFICATE OF ACCURACY

I hereby state that to the best of my knowledge, information and belief, that the survey hereon was made in accordance with the requirements of the minimum standards manual practice of land surveying in South Carolina, and meets and or exceeds the requirements for a class "B" survey as specified therein.

DATE _____ REGISTERED SURVEYOR
S. C. Registration No. **18266**

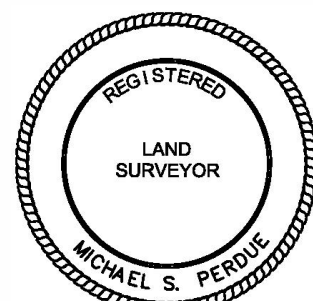
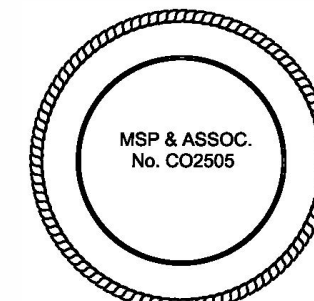

0000-0000

RECOMBINATION PLAT

NO. OF ACRES: 1.239 ACRES
MILES OF NEW ROAD: 0
NO. OF LOTS: 2
DATE: MAY 5, 2020
ZONE: O-D
LOCATION: GREENVILLE, SC

